

Quick Start Guide

Thermal Transfer Overprinter

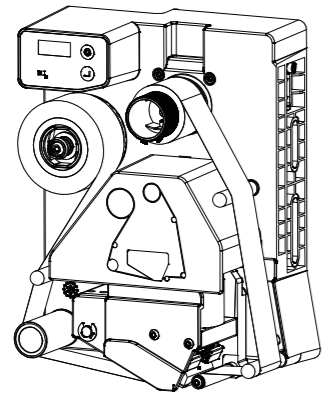

Content

| | |
|---|----|
| 1.Packing List | 1 |
| 2.Appearance & Components | 2 |
| 3.Printer Mounting & Power Supply | 3 |
| 4.Change of Print Direction | 7 |
| 5.Wiring Guidance | 11 |



Access to App

1.Packing List

■ Standard

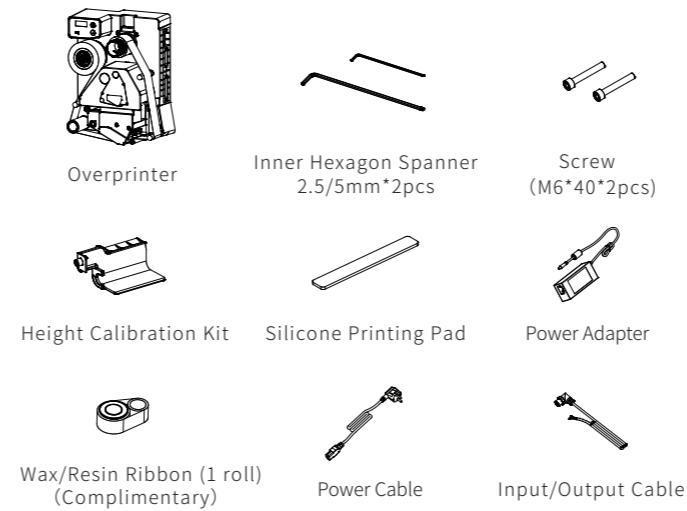

■ Optional

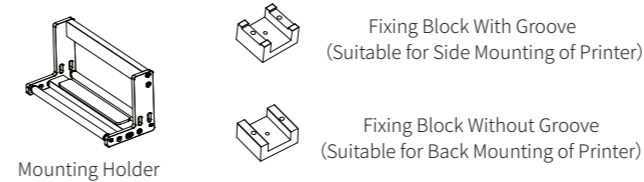

- 1 -

2.Appearance & Components

■ Front

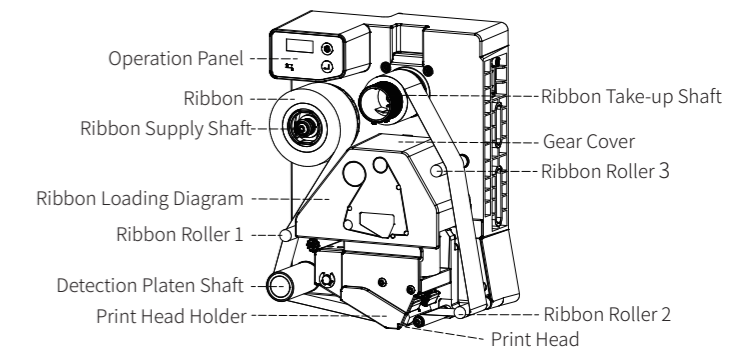

■ Rear

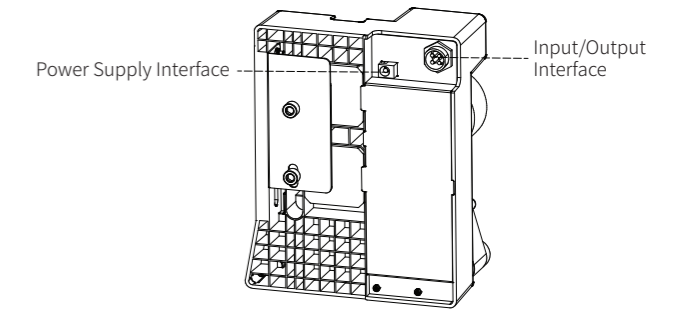

- 2 -

3.Printer Mounting & Power Supply

1. Stick the silicone pad onto the silicone pad support.
2. Fix the overprinter into the mounting holder of the overprinter by two screws (M6*40*2pcs).

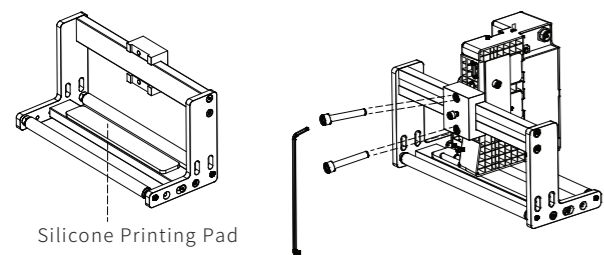

3. Move the print head unit to the left.
4. Install the height calibration kit to the position as shown in the figure below.

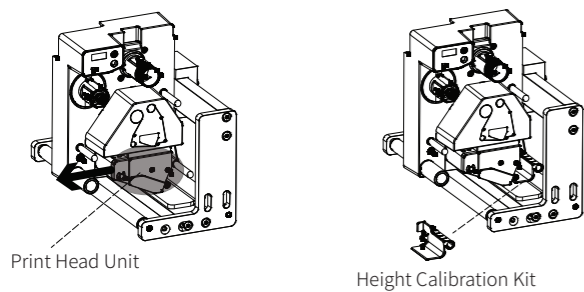

- 3 -

5. Move the print head unit to the right to ensure its position is in place. (When the peeling roller is stuck into the groove of the height calibration kit, it's in place. Please refer to the details below.)

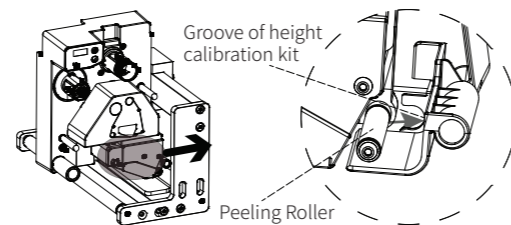

6. Loosen the two mounting screws and one calibrating screw to calibrate the height (as shown below: hold the overprinter top and press it down, and hold the print head unit and the overprinter main body, so as to straighten the angle of the overprinter to ensure that the height calibration kit is flat with the silicone pad). Then tighten the three screws.

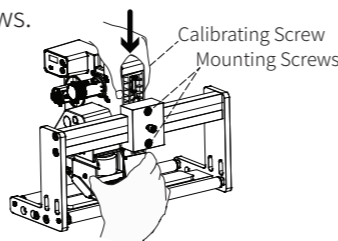

- 4 -

7. Move the print head unit to the left and remove the height calibration kit.
8. Push the overprinter fixing block to see if it can slide to left or right. If it can, tighten the screw to fix it.

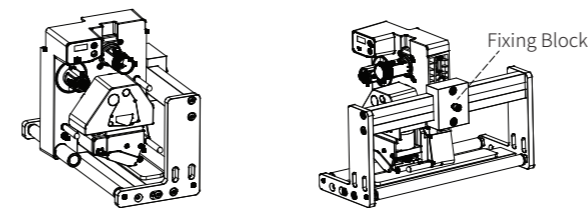

9. Install the ribbon according to the ribbon loading diagram. Pay attention to keep the ribbon flat, and the direction of the ribbon when going round the rollers and shaft (as shown in the figure below).
10. After having the ribbon loaded, rotate the ribbon take-up shaft counterclockwise to ensure that the ribbon is tightened.

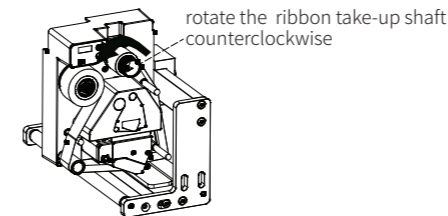

- 5 -

11. Reload the packing film.
12. Connect the signal cable and power supply cable.
 - ① Insert the signal cable into the input/output interface;

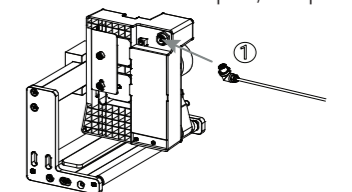

- ② Insert the adapter into the power supply interface;
- ③ Connect the adapter to the power cable;
- ④ Insert the power plug into a nearby socket, so the power supply connection is complete;
- ⑤ After completing the above steps, the overprinter will automatically turn on and wrap a small piece of ribbon around the rollers. Now, the overprinter is in standby mode.

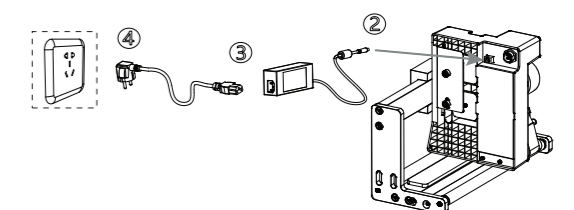

⚠ Note: Do connect the signal cable before the power supply cable.

- 6 -

4. Change of Print Direction

1. Pull out the power cable and input/output signal cable on the overprinter.
2. Remove the two mounting screws with an inner hexagon spanner to separate the overprinter and the mounting holder.

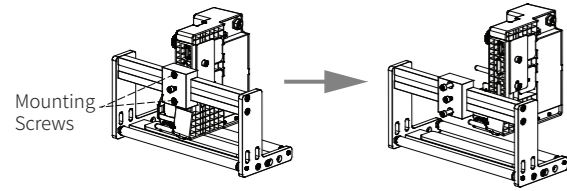

3. Remove the two screws on the mounting holder and lock them into the two screw holes on the side of the overprinter.

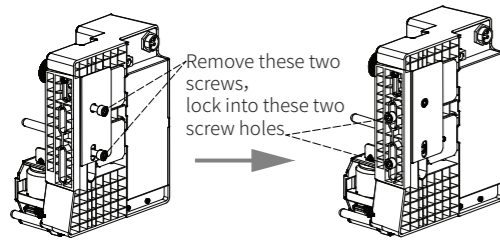

- 7 -

4. ① Remove the screws on both sides of silicone pad support (total: 4pcs); ② Move the silicone pad support forward a distance of a screw hole; ③ Lock the silicone pad support with the four screws.

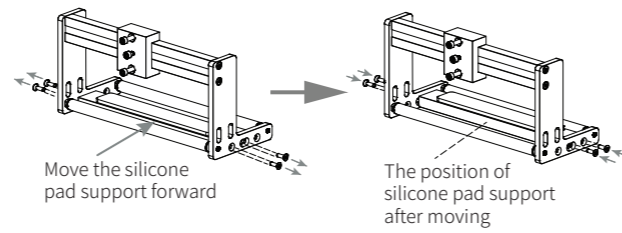

5. Fix the overprinter to the holder in the direction shown below, and lock the screws on the fixing block.

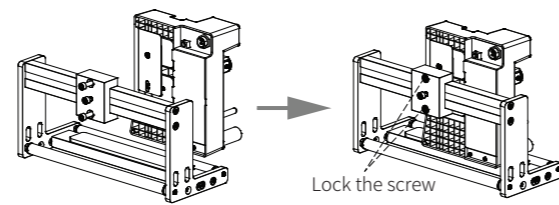

- 8 -

6. Move the print head unit to the left and install the height calibration kit to the position shown in the figure below.

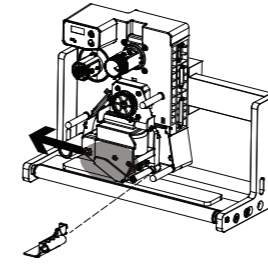

7. Move the print head unit to the right to ensure its position is in place. (When the peeling roller is stuck into the groove of the height calibration kit, it's in place.)

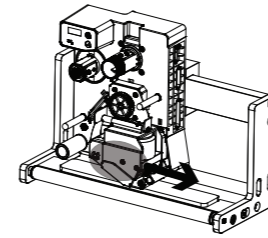

- 9 -

8. Loosen the three calibrating screws to calibrate the height (as shown below: hold the overprinter top and press it down, and hold the print head unit and the overprinter main body, so as to straighten the angle of the overprinter and ensure that the height calibration kit is flat with the silicone pad). Then tighten the three screws.

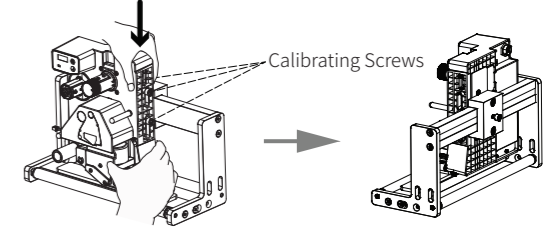

9. Move the print head unit to the left and remove the height calibration kit, so the change of print direction is complete.

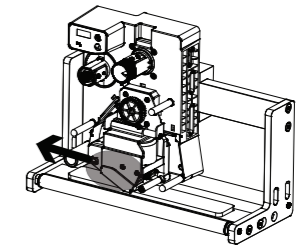

- 10 -

5. Wiring Guidance

1. To enable the overprinter packaging interlock alarm output, follow the four steps to remove the X3 jumper from the circuit board.

- ① Remove the two screws in the figure below with a cross screwdriver; remove one nut in the figure below with a 19mm opening spanner, and remove the rear cover of the overprinter.

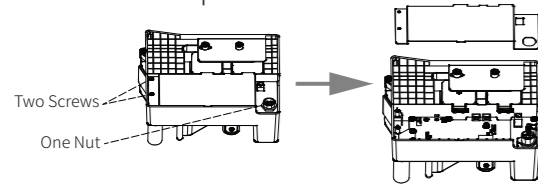

- ② Remove the jumper cap.

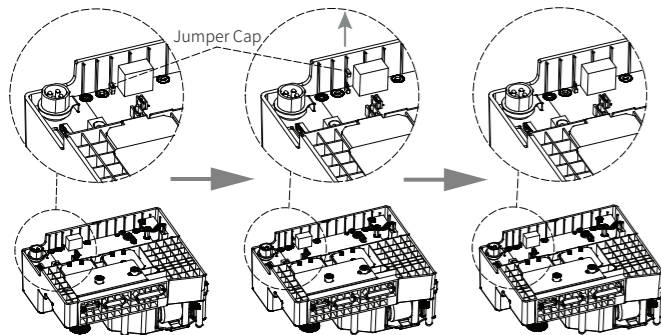

- 11 -

- ③ Put the rear cover of the overprinter back and lock the 2 screws and 1 nut.

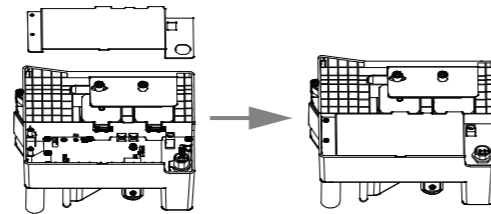

- ④ Connect the input/output signal cable.

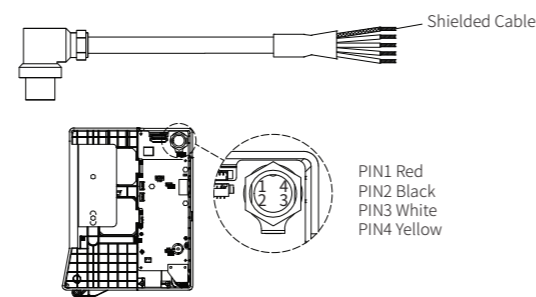

- 12 -

Table for connecting the input/output signal cable:

| Interface 1 | Cable Colour | Function: remove jumper X3 (enable the fault output signal) | Function: keep jumper X3 (disable the fault output signal) |
|----------------|--------------|---|--|
| PIN1 | Red | Print input signal | Print input signal |
| PIN2 | Black | Fault relay N/C (no-voltage) | No need |
| PIN3 | White | Fault relay COM (no-voltage) | Ground cable / 0V DC |
| PIN4 | Yellow | DC+24V (printer self-supplied) | |
| Shielded Cable | | Ground cable / 0V DC | No need |

2. Alarm output wiring (X3 jumper removed)

| | | | |
|--|---|---|---|
| Overprinter relay signal No fault-Off | Set the "alarm parameter" of the overprinter to 1 (=normally closed) in the App | Overprinter 1/0 connector interface 1 3 COM white cable 2 N/C black cable | +24V (PLC Supply) _Input (PNP) PLC _0V (PLC Supply) |
| At fault- disconnected | Set the "alarm parameter" of the overprinter to 0 (=normally open) in the App | Overprinter 2 N/C black cable 1/0 connector interface 1 3 COM white cable | +24V (PLC Supply) _Input (NPN) PLC _0V (PLC Supply) |

Set the alarm parameter for overprinter:

- ① Run the thermal transfer overprinter App on the phone, and connect App to the overprinter;
- ② Go to "Control Overprinter" -> "Settings" -> "My Overprinter";
- ③ Set the "Alarm Parameter" to 0 or 1 (factory set to 1).

- 13 -

3. Print input wiring

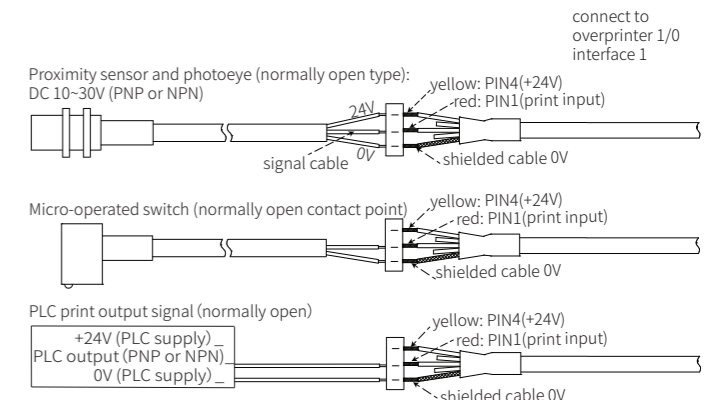

⚠ Notes:

- ① The alarm output wiring and the print input wiring do not affect each other.
- ② Since the App keeps updating, please take the actual interface during operating.

Set the external input mode of the overprinter:

- ① Run the thermal transfer overprinter App on the phone, and connect App to the overprinter;
- ② Go to "Control Overprinter" -> "Device Settings" -> "Print Signal Trigger Mode";
- ③ Set the external input mode to NPN or PNP.

- 14 -